

HURRICANE BACKWRAP COMPRESSION BOARD AIR SEAL
 UP TO 120 MPH WIND RIDER *
 C-EPDM MEMBRANE
 REPAIR TO VERTICAL WALL ANGLE CHANGE TERMINATION

COMPRESSION BOARD AIR SEAL

MINIMUM 1/2" CDX PLYWOOD OR 7/16" OSB BOARD

- A) 2' COMPRESSION BOARD ON BUILDINGS
29' OR LESS IN HEIGHT AND INTERNAL PENETRATIONS
- B) 4' COMPRESSION BOARD ON BUILDINGS
30' OR HIGHER OR 90 MPH OR GREATER WIND RIDERS
FASTENED WITH #14 ROOF SCREWS AND 2" FLAT WASHERS

Note: 2001 Co. recommends using reinforced membrane under and over compression board for ease of workmanship

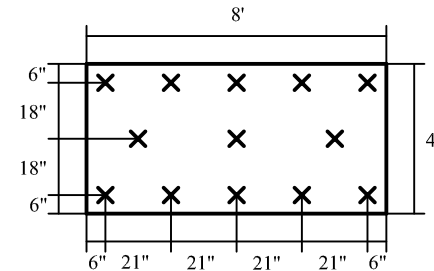
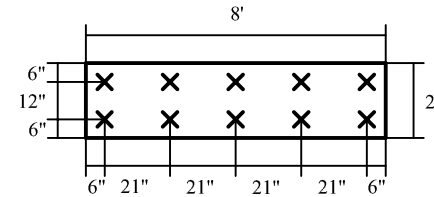

*FOR WIND RIDER OF OVER 60 MPH, VERIFICATION OF EXISTING ROOF ATTACHMENT TO THE DECK IS REQUIRED.
 SOME EXISTING ROOFS MAY REQUIRE PERIMETER CORNER AND SUBSTRATE REFASTENING.

© Thomas L. Kelly - Patent Pending

HURRICANE BACKWRAP COMPRESSION BOARD AIR SEAL
 UP TO 120 MPH WIND RIDER

325 Thomaston Ave. P.O. Box 2557 Waterbury, CT 06702 Tele: 1 (800) 537-7663	Scale: NTS DWG #: TP-HOB-120 Rev. Date: 5/24/11 Rev. #: 7
--	--