

HURRICANE BACKWRAP COMPRESSION BOARD AIR SEAL
 WITH RAISED GRAVEL STOP PERIMETER
 UP TO 120 MPH WIND RIDER *
 THERMOPLASTIC MEMBRANE PVC, TPO, ETC
 REPAIR TO PERIMETER GRAVEL STOP EDGE

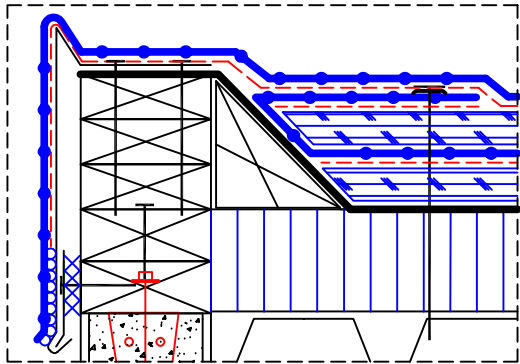

ALTERNATE FINISH

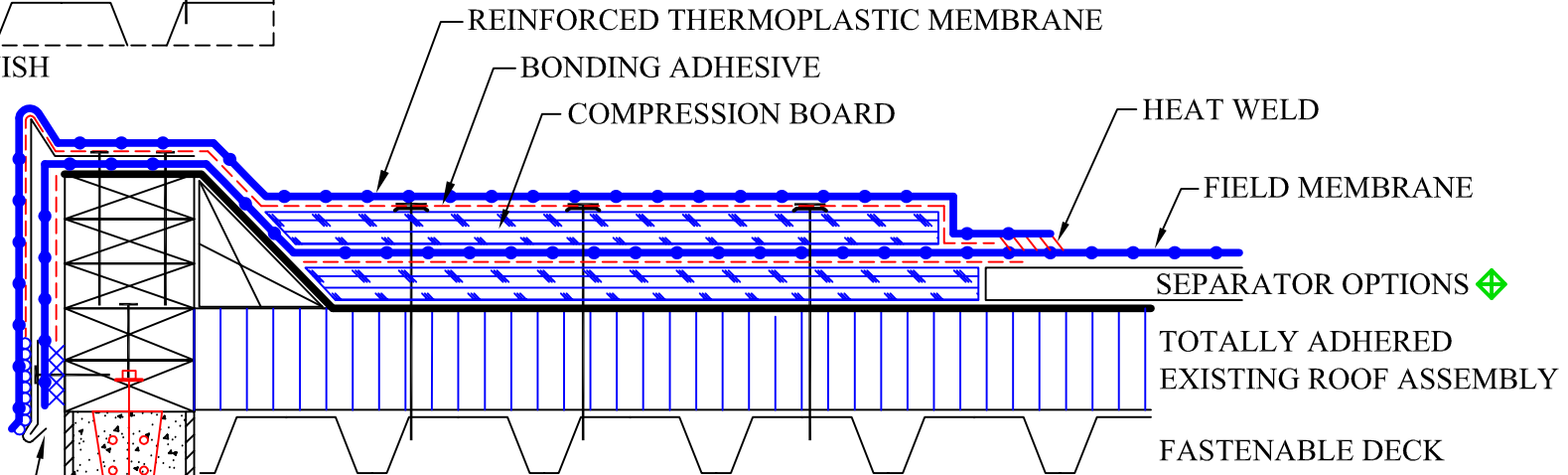

SCREW TERM BAR,
 NEW CATCH CLEAT,
 OR FASTEN BOTTOM
 OF EXISTING GRAVEL
 STOP WITH 3" FLAT
 HEAD SCREWS,
 STAGGERED 6" ON
 CENTER. NO NAILS,
 SCREWS ONLY

COMPRESSION BOARD AIR SEAL

MINIMUM 1/2" CDX PLYWOOD OR 7/16" OSB BOARD

- A) 2' COMPRESSION BOARD ON BUILDINGS
 29' OR LESS IN HEIGHT AND INTERNAL PENETRATIONS
- B) 4' COMPRESSION BOARD ON BUILDINGS
 30' OR HIGHER AND 90 MPH OR GREATER WIND RIDERS
 FASTENED WITH #14 ROOF SCREWS AND 2" FLAT WASHERS

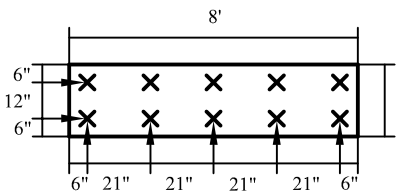
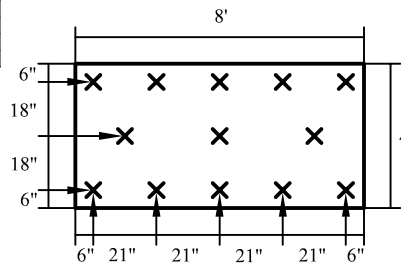

SEPARATOR OPTIONS:

- 1) 2001 GRAVEL MAT
- 2) 1/2" GYPSUM LOOSE LAID OR DENS DECK
- 3) INSULATION MECHANICALLY
 FASTENED WITH 8 FASTENERS
 PER 4X8 PANEL AND 4 FASTENERS
 PER 4X4 TO KEEP FROM BOWING
- 4) INSULATION LOOSE LAID AND
 WEIGHTED IN PLACE WITH 1/2" GYPSUM,
 DENS DECK, OR EQUAL

* FOR WIND RIDER OF OVER 60 MPH, VERIFICATION OF EXISTING ROOF ATTACHMENT TO THE DECK IS REQUIRED.
 SOME EXISTING ROOFS MAY REQUIRE PERIMETER CORNER AND SUBSTRATE REFASTENING.

HURRICANE BACKWRAP COMPRESSION BOARD AIR SEAL
 UP TO 120 MPH WIND RIDER

325 Thomaston Ave.	Scale: NTS
P.O. Box 2557	DWG #: TP-HCB-100-RGS
Waterbury, CT 06702	Rev. Date: 5/24/11
Tele: 1 (800) 637-7663	Rev. #: 9