

# HURRICANE BACKWRAP COMPRESSION BOARD AIR SEAL

## UP TO 120 MPH WIND RIDER \* THERMOPLASTIC MEMBRANE PVC, TPO, ETC

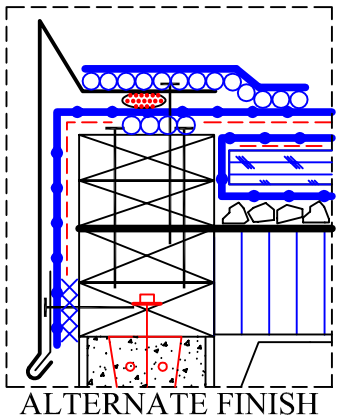

GRAVEL STOP FASTENED 6" O.C. WITH #12 WOOD SCREWS AND STAGGER FASTENERS TO KEEP NAILER FROM SPLITTING

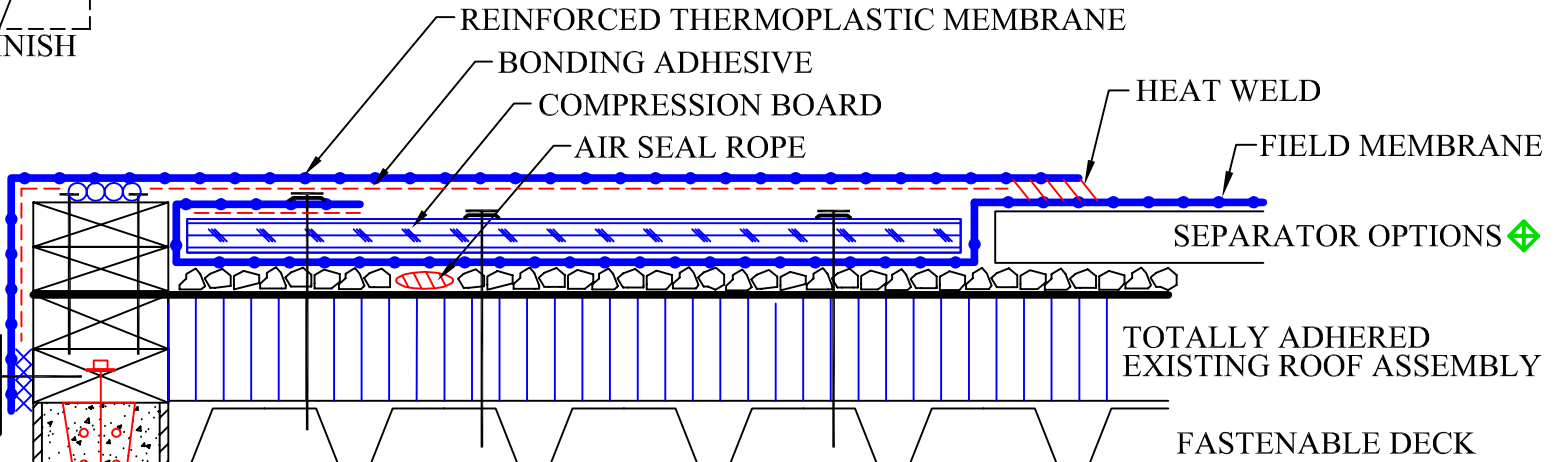

SCREW TERM BAR, NEW CATCH CLEAT, OR FASTEN BOTTOM OF EXISTING GRAVEL STOP WITH 3" FLAT HEAD SCREWS, STAGGERED 6" ON CENTER. NO NAILS, SCREWS ONLY

### COMPRESSION BOARD AIR SEAL

MINIMUM  $\frac{1}{2}$ " CDX PLYWOOD OR  $\frac{7}{16}$ " OSB BOARD

- A) 2' COMPRESSION BOARD ON BUILDINGS 29' OR LESS IN HEIGHT AND INTERNAL PENETRATIONS
- B) 4' COMPRESSION BOARD ON BUILDINGS 30' OR HIGHER AND 90 MPH OR GREATER WIND RIDERS FASTENED WITH #14 ROOF SCREWS AND 2" FLAT WASHERS

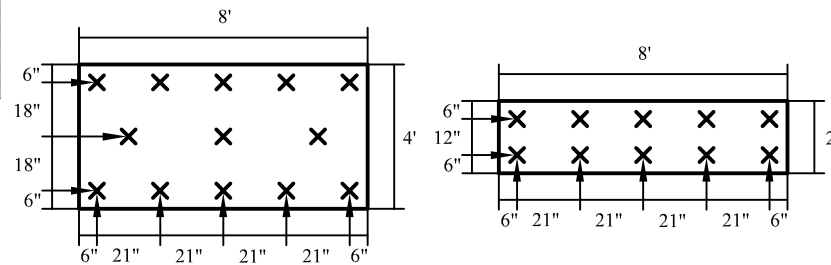

### SEPARATOR OPTIONS:

- 1) 2001 GRAVEL MAT
- 2)  $\frac{1}{2}$ " GYPSUM LOOSE LAID OR DENS DECK
- 3) INSULATION MECHANICALLY FASTENED WITH 8 FASTENERS PER 4X8 PANEL AND 4 FASTENERS PER 4X4 TO KEEP FROM BOWING
- 4) INSULATION LOOSE LAID AND WEIGHTED IN PLACE WITH  $\frac{1}{2}$ " GYPSUM, DENS DECK, OR EQUAL

\* FOR WIND RIDER OF OVER 60 MPH, VERIFICATION OF EXISTING ROOF ATTACHMENT TO THE DECK IS REQUIRED. SOME EXISTING ROOFS MAY REQUIRE PERIMETER CORNER AND SUBSTRATE REFASTENING.

© Thomas L. Kelly - Patent Pending

Hurricane Backwrap Compression Board Air Seal  
Up to 120 MPH Wind Rider

325 Thomaston Ave.	Scale: NTS
P.O. Box 2557	DWG #: TP-HCB-120A
Waterbury, CT 06702	Rev. Date: 5/24/11
Tele: 1 (800) 537-7663	Rev. #: 7