

Earthquake Spring Flange Airseal over Wall Expansion Joint

Direct Membrane Termination To Vertical Wall
 With Floating Tapered Crickets For Water Flow
 C-EPDM Totally Adhered To A Weighted Board
 Up To 80 MPH *

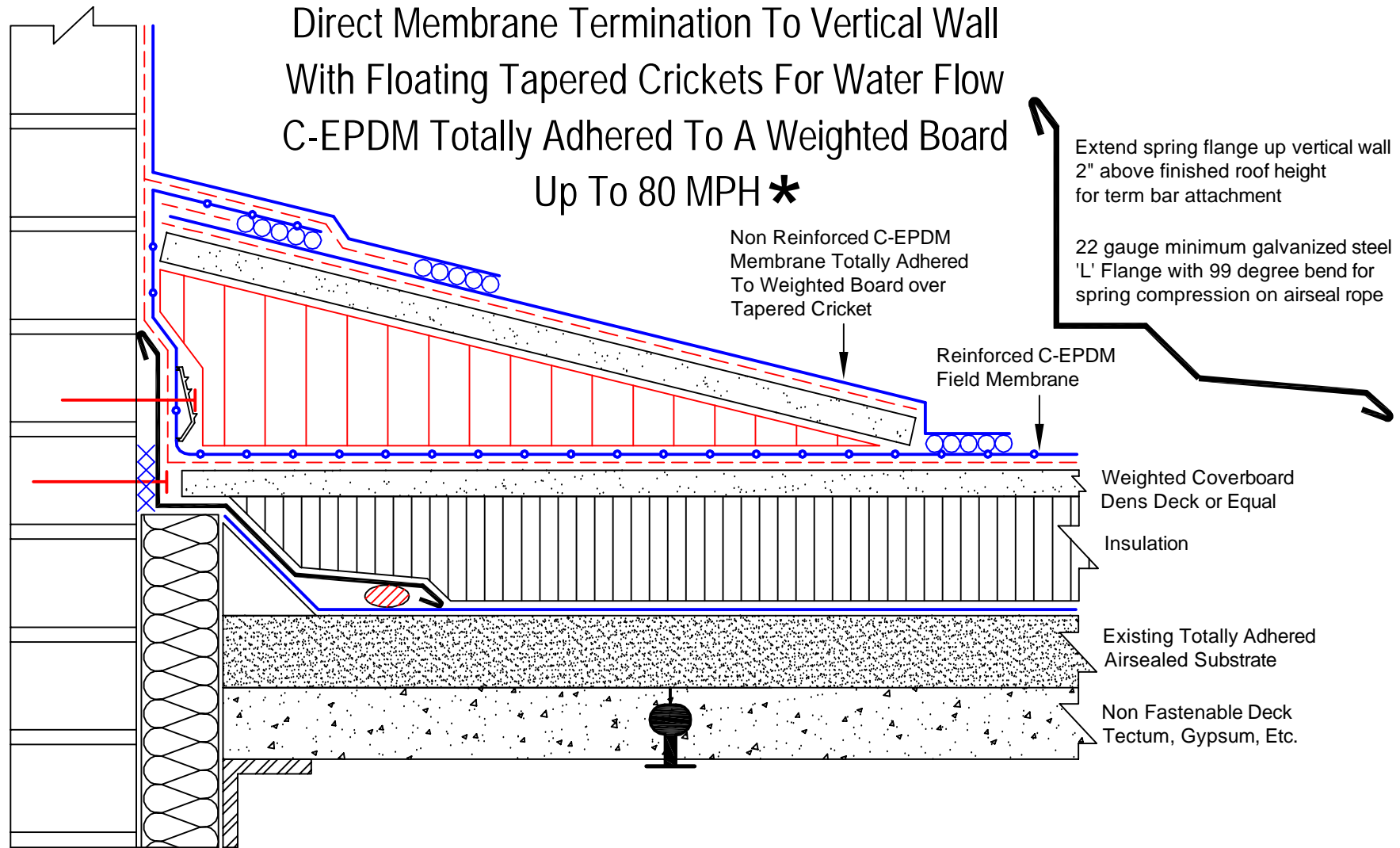

Extend spring flange up vertical wall 2" above finished roof height for term bar attachment

22 gauge minimum galvanized steel 'L' Flange with 99 degree bend for spring compression on airseal rope

Non Reinforced C-EPDM Membrane Totally Adhered To Weighted Board over Tapered Cricket

Reinforced C-EPDM Field Membrane

Weighted Coverboard Dens Deck or Equal

Insulation

Existing Totally Adhered Airsealed Substrate

Non Fastenable Deck Tectum, Gypsum, Etc.

* For greater than 80 MPH Wind Rider, the Wall To Deck Air Seal must be approved by 2001 Co. for specific Wall To Deck Construction.

C-EPDM-SFAS/DMT-80-VW+FC

	4" Seam Tape
	Adhesive
	Insulation
	2001 Term. Bar Tape

	Air Seal Rope
	Gypsum
	Concrete
	Existing Roof

Spring Flange Air Seal Over Wall Expansion Joint	
Dwg #: C-EPDM-SFAS/DMT-80-VW+FC	
Rev. Date: 3/24/11	Drawn by: Delventhal
Dwg. Date: 7/19/10	Approved by: LeRoy

2001 Company

325 Thomaston Av.
 P.O. Box 2557
 Waterbury, CT 06702-2557

© Thomas L. Kelly - Patent Pending