

C-Channel Air Seal - 100 mph+ Wind Rider

Deck to Wall Reinforced EPDM or
Mod Bit Adhesive Hot Mopped or
Hot Air Installed on roof to height of finish roof

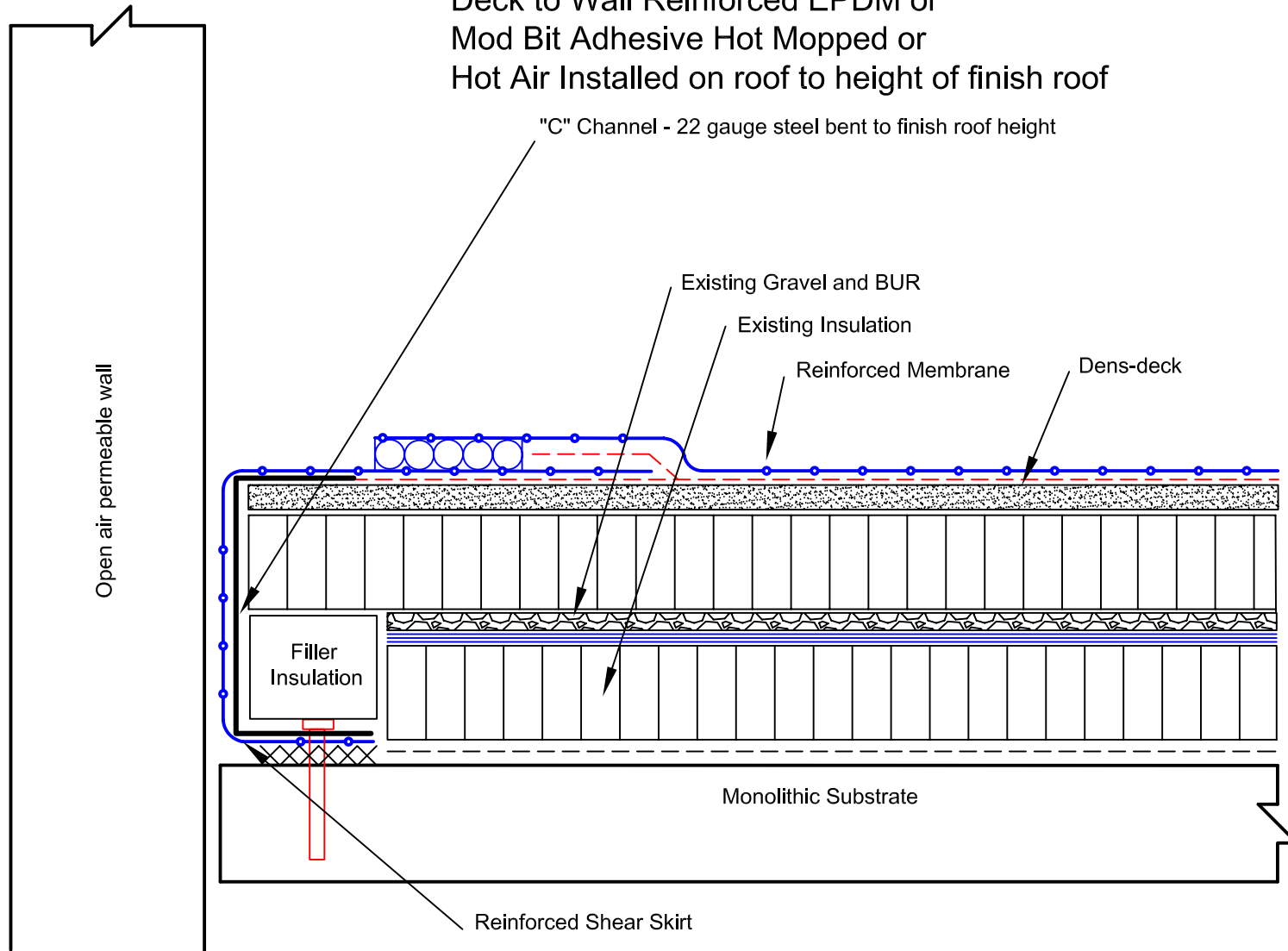

- 4" Seam Tape
- Adhesive
- Insulation
- Air Seal Rope

- Concrete
- OSB Board
- Gypsum

| C-Channel Air Seal | |
|---------------------------|--------------|
| Dwg #: AirSeal(CChannel)2 | Drawn by: BH |
| Rev. Date: | Approved by: |
| Dwg. Date: 5/30/06 | Scale: NTS |

2001 Company

325 Thomaston Av.
P.O. Box 2557
Waterbury, CT 06702-2557

© Thomas L. Kelly - Patent Pending