

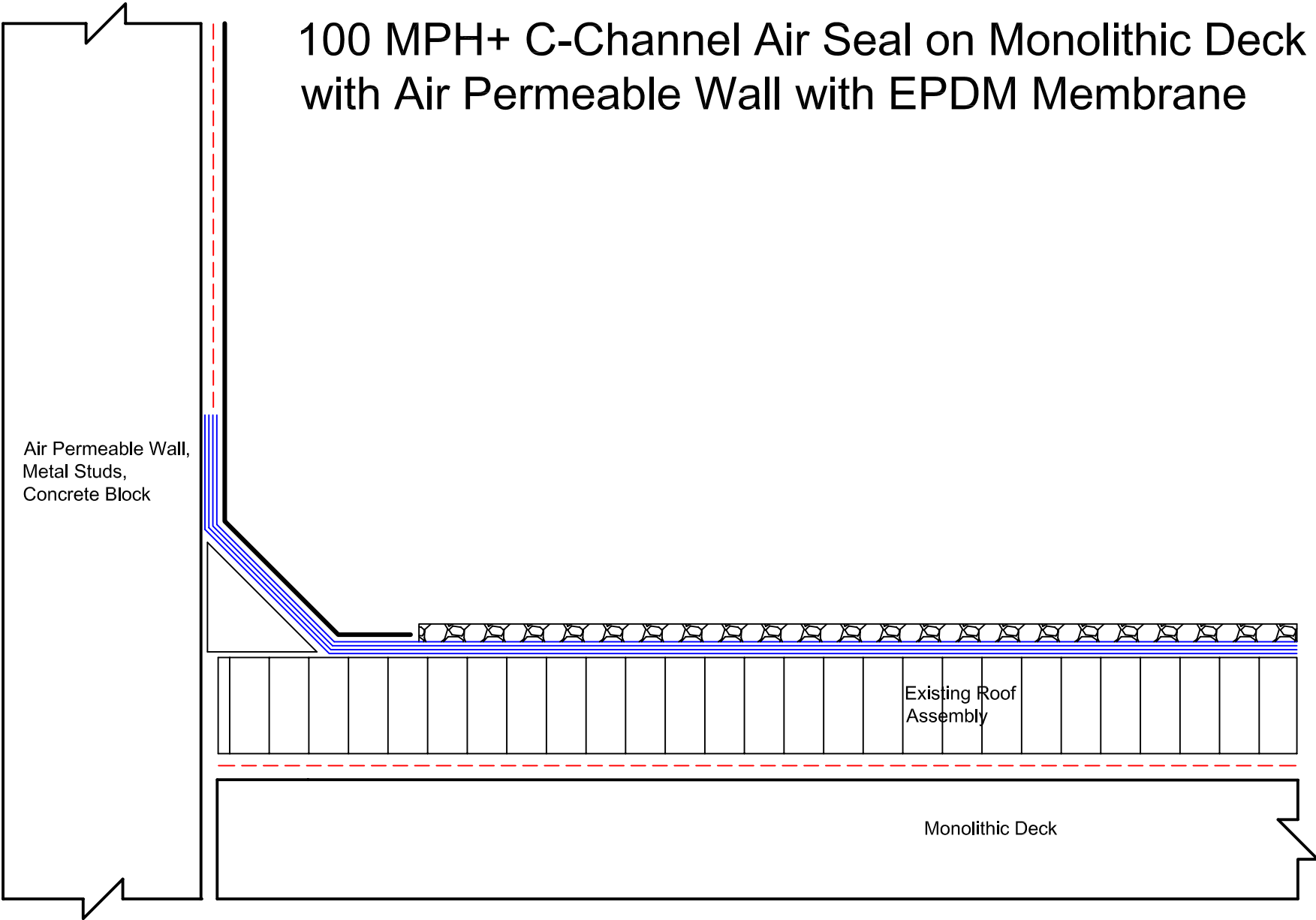

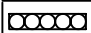



# 100 MPH+ C-Channel Air Seal on Monolithic Deck with Air Permeable Wall with EPDM Membrane

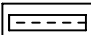
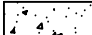

	4" Seam Tape		Concrete
	Adhesive		OSB Board
	Insulation		Gypsum
	Air Seal Rope		

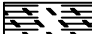
Existing Roof System 1/3	
Dwg #:	Drawn by: BH
Rev. Date:	Approved by:
Dwg. Date: 5/30/06	Scale: NTS

**2001 Company**  
 325 Thomaston Av.  
 P.O. Box 2557  
 Waterbury, CT 06702-2557  
 © Thomas L. Kelly - Patent Pending